



**Microsoft**

**Exam Questions PL-500**

Microsoft Power Automate RPA Developer

NEW QUESTION 1

- (Exam Topic 1)

You need to ensure that the solution uses the correct accounts payable mailbox. Which three actions should you perform? Each correct answer part of the solution, NOTE: Each correct selection is worth one point.

- A. Set the current value for the accounts payable mailbox in the environment.
- B. Set the default value for the accounts payable mailbox in the environment.
- C. Turn off and then turn on the cloud flows.
- D. Use separate environment variables for the cloud flow and the canvas app.
- E. Use one environment variable for both the cloud flows and the canvas app.

Answer: ACD

NEW QUESTION 2

- (Exam Topic 1)

You need to resolve the fulfillment status flow issue.

Which three actions should you perform? Each correct answer presents part of the solution. NOTE: Each correct selection is worth one point.

- A. Ensure that the flow instance does not remain in the queue for more than three hours.
- B. Ensure that the flow is not using elevated privileges.
- C. Ensure that all users are signed out from the target machine.
- D. Use different local Windows accounts for all machines.
- E. Trigger the flow by using an on-premises data gateway.

Answer: BDE

NEW QUESTION 3

- (Exam Topic 1)

You need to configure the solution.

What should you use? To answer, select the appropriate options in the answer area. NOTE: Each correct selection is worth one point.

Answer Area

Requirement	Option
Automate the SMSApp data entry process.	<div>Action</div> <div>Workflow</div> <div>Desktop flow</div> <div>Mobile task flow</div>
Handle invoices sent to the Accounts payable mailbox.	<div>When a folder is created</div> <div>When an item is created</div> <div>When a new email arrives</div> <div>When a new email arrives in a shared mailbox</div>
Implement the order process.	<div>Workflows</div> <div>Instant flows</div> <div>Business rules</div> <div>Business process flows</div>

- A. Mastered
- B. Not Mastered

Answer: A

Explanation:

Answer Area

Requirement	Option
Automate the SMSApp data entry process.	<div>Action</div> <div>Workflow</div> <div>Desktop flow</div> <div>Mobile task flow</div>
Handle invoices sent to the Accounts payable mailbox.	<div>When a folder is created</div> <div>When an item is created</div> <div>When a new email arrives</div> <div>When a new email arrives in a shared mailbox</div>
Implement the order process.	<div>Workflows</div> <div>Instant flows</div> <div>Business rules</div> <div>Business process flows</div>

NEW QUESTION 4

- (Exam Topic 1)

You need to determine the causes for the reported issues.

What are the causes? To answer, select the appropriate options in the answer area. NOTE: Each correct selection is worth one point.

Answer Area	
Issue	Cause
New environment	Flow checker did not run. Admin mode is turned on. Admin mode is turned off. A connector was added to a DLP policy.
FlowA	The user is in the wrong environment. The user does not have the correct permissions.
Dataverse error	There is no Microsoft Dataverse database provisioned. The user did not sign into Power Automate by using a Microsoft work account. Microsoft Dataverse was not shared with the user from the development environment.

- A. Mastered
- B. Not Mastered

Answer: A

Explanation:

Answer Area	
Issue	Cause
New environment	Flow checker did not run. Admin mode is turned on. Admin mode is turned off. A connector was added to a DLP policy.
FlowA	The user is in the wrong environment. The user does not have the correct permissions.
Dataverse error	There is no Microsoft Dataverse database provisioned. The user did not sign into Power Automate by using a Microsoft work account. Microsoft Dataverse was not shared with the user from the development environment.

NEW QUESTION 5

- (Exam Topic 1)

You need to configure the flow for processing invoices that arrive in the AP mailbox. Which three elements should you use? Each correct answer presents part of the solution. NOTE: Each correct selection is worth one point.

- A. Document type
- B. Location
- C. Pages
- D. AI model
- E. Form type
- F. Form

Answer: BCE

NEW QUESTION 6

- (Exam Topic 1)

You need to identify the cause for the SMSApp data entry issue. What is the root cause?

- A. The DLP policy that contains the desktop flow connector was deleted.
- B. The default policy group is set to Blocked.
- C. The desktop flow was not shared with the finance clerk.
- D. The scope of the DLP policy was changed to exclude the development environment
- E. The Power Automate Management connector is assigned to the Business category.

Answer: C

NEW QUESTION 7

- (Exam Topic 2)

You need to address the issue with the capacity planning flow. What should you do?

- A. Increase the CPU and memory of the machine on which the gateway is hosted.
- B. Create a gateway cluster.
- C. Configure the system to send alerts when the gateway fails.
- D. Create a machine group and add machines to the group to handle requests.

Answer: D

NEW QUESTION 8

- (Exam Topic 2)

You need to configure the RailStatusUpdater cloud flow. What should you do?

- A. Create a JavaScript function to update the run mode values of each action within the desktop flow.
- B. Create an environment variabl
- C. Update each desktop flow action to read the variable.
- D. Manually update each desktop flow action to change the run mode.
- E. Create a desktop flow to update the run mode values of each action within the cloud flow.

Answer: A

NEW QUESTION 9

- (Exam Topic 2)

You need to configure the solution for the ERPDataOperations flow.

Which configuration values should you use? To answer, select the appropriate options in the answer area, NOTE: Each correct selection is worth one point.

Answer Area

Configuration setting	
Type of trigger to use	<div>When a new email arrives</div> <div>When a new event is created</div> <div>When a new row is created or modified</div> <div>When a new item is created or modified</div>
Type of variables to use in the desktop flow to access credentials	<div>Set</div> <div>Input</div> <div>Output</div> <div>Compose</div>

- A. Mastered
- B. Not Mastered

Answer: A

Explanation:

Answer Area

Configuration setting	
Type of trigger to use	<div>When a new email arrives</div> <div>When a new event is created</div> <div>When a new row is created or modified</div> <div>When a new item is created or modified</div>
Type of variables to use in the desktop flow to access credentials	<div>Set</div> <div>Input</div> <div>Output</div> <div>Compose</div>

NEW QUESTION 10

- (Exam Topic 3)

A user is evaluating the capabilities of both process mining and task mining. You need to determine when you should use process mining or task mining.

Which Process advisor capability should you use? To answer, drag the appropriate capabilities to the correct requirements. Each capability may be used once, more than once, or not at all. You may need to drag the split bar between panes or scroll to view content.

NOTE: Each correct selection is worth one point.

Capabilities		Requirement	Capability
Process mining		See the actual steps used to perform a process.	Capability
Task mining		Reduce process time by evaluating event data from a system of record.	Capability
		Understand what employees do while performing each task.	Capability
		Identify the most common actions based on user interactions.	Capability

- A. Mastered



B. Not Mastered

Answer: A

Explanation:

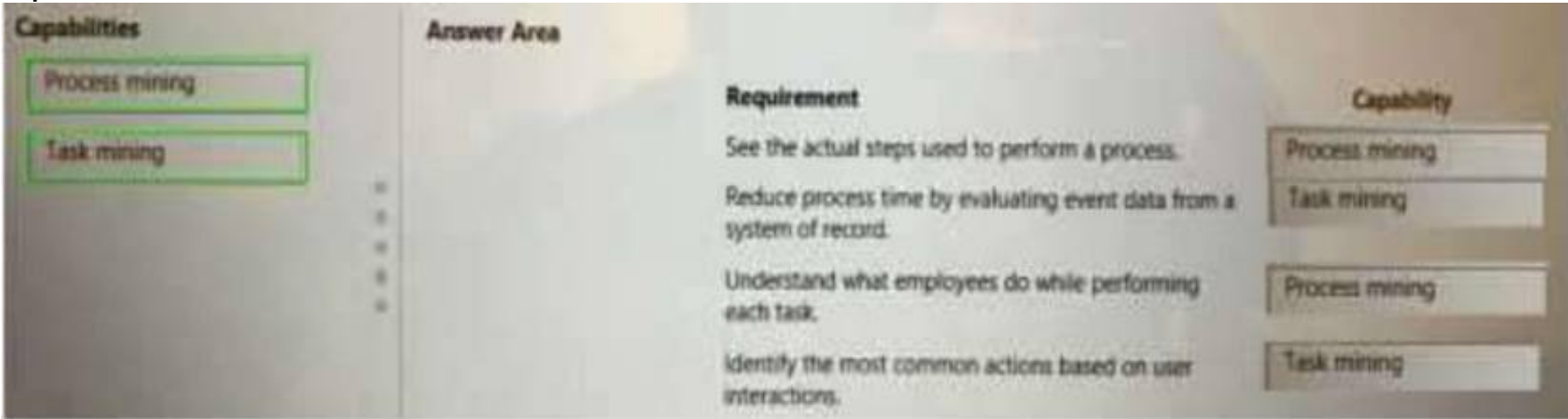

NEW QUESTION 10

- (Exam Topic 3)

You plan to implement a data loss prevention (DLP) policy for a production environment. You need to define the policy. Which four actions should you perform in sequence? To answer, move the appropriate actions from the list of actions to the answer area and arrange them in the correct order.

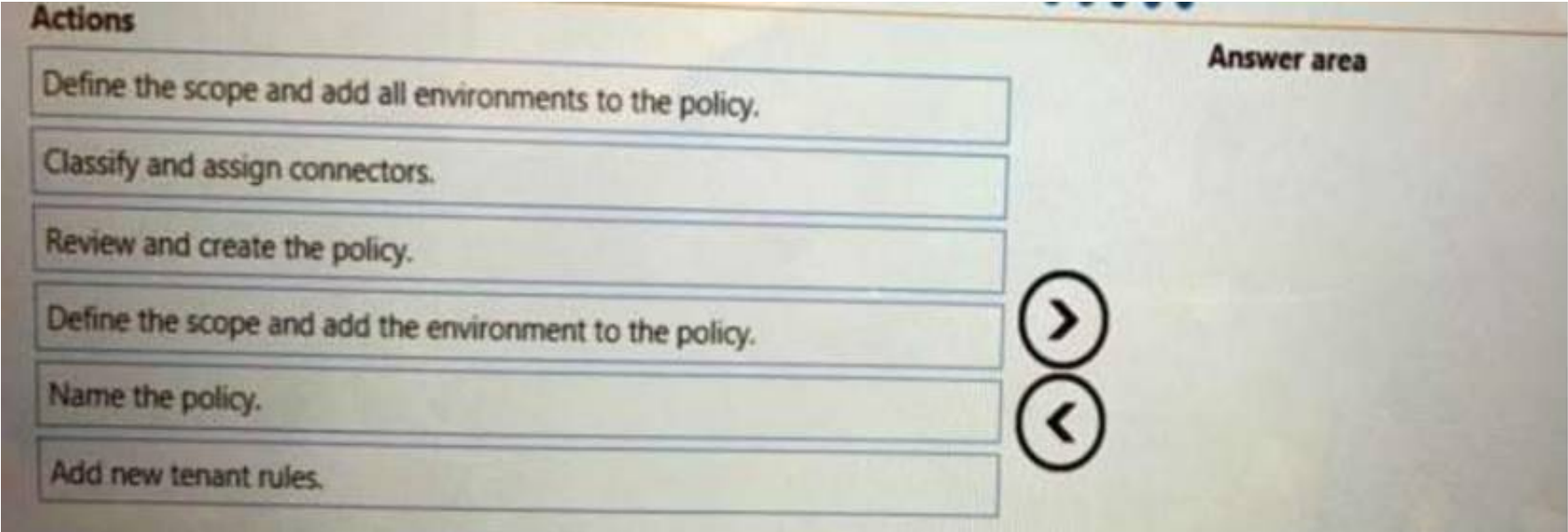

A. Mastered  
B. Not Mastered

Answer: A

Explanation:

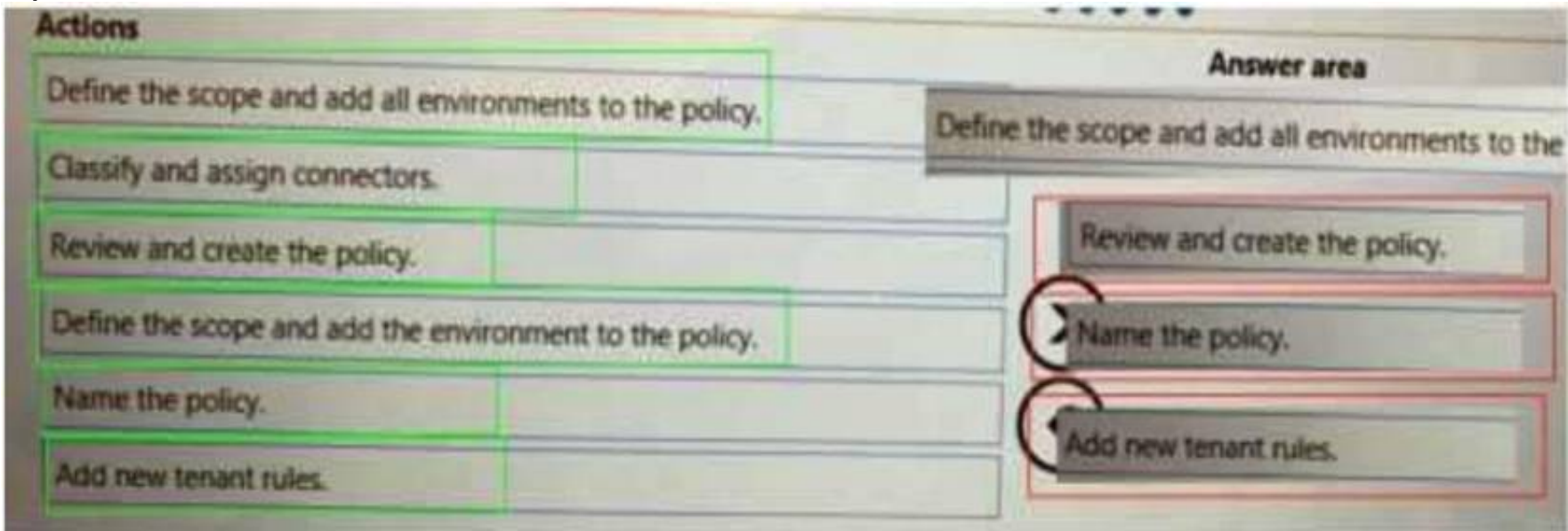

NEW QUESTION 11

- (Exam Topic 3)

You are developing automation solutions for a company. You need to use an environment variable in a cloud flow. Which three actions should you perform in sequence? To answer, move the appropriate actions from the list of actions to the answer area and arrange them in the correct order.

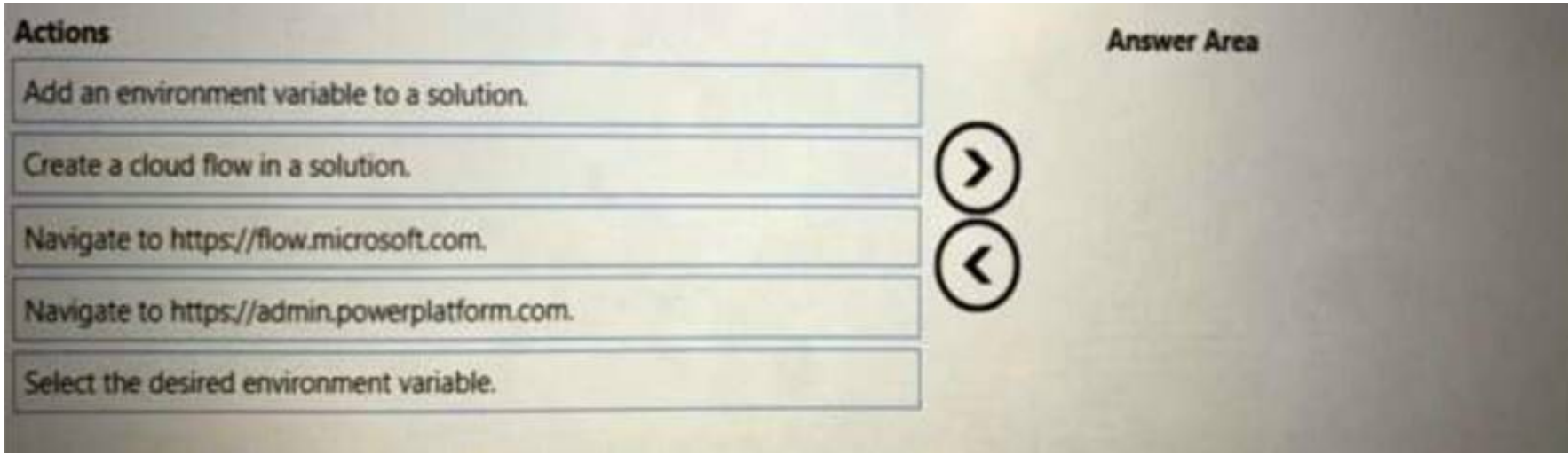

- A. Mastered
- B. Not Mastered

Answer: A

Explanation:

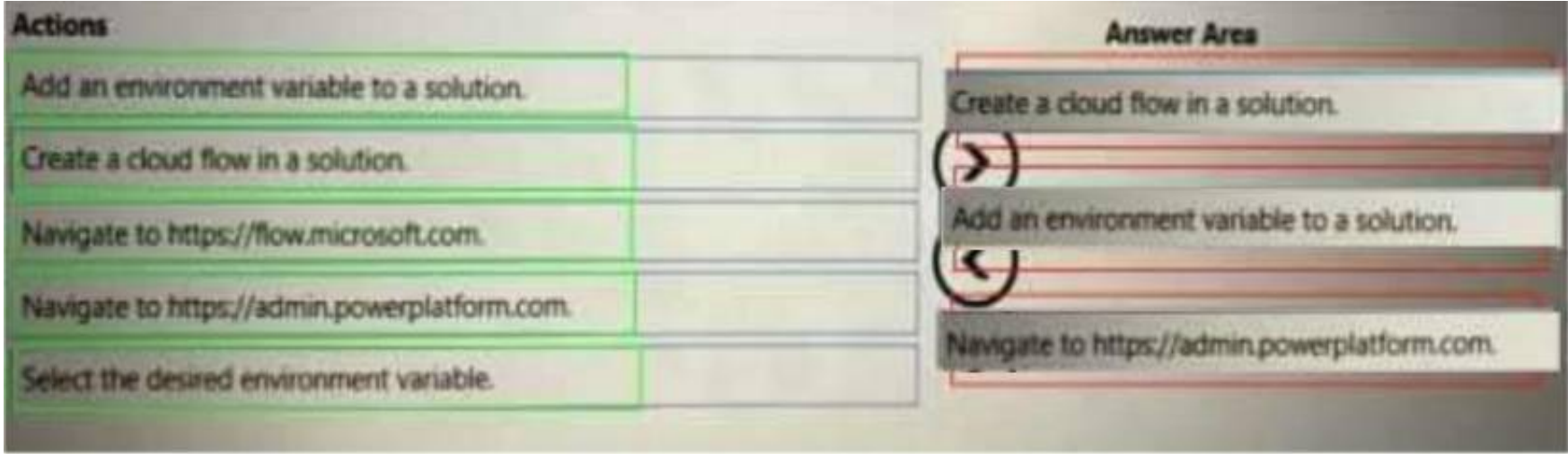

NEW QUESTION 13

- (Exam Topic 3)  
You are developing automation solutions that process sensitive employee data for a company. You plan to implement the sensitive variables feature in Power Automate for desktop.  
What are three characteristics of the sensitive variables feature? Each correct answer presents a complete solution.  
NOTE: Each correct selection is worth one point.

- A. Only variables that are passwords can be marked as sensitive.
- B. You can view the values of variables marked as sensitive within desktop flow logs by using the Microsoft Power Platform admin center.
- C. Sensitive variables are not visible within desktop flow logs in the Power Automate portal.
- D. You can mark any variable as sensitive.
- E. You can reference and manipulate variables that are marked as sensitive from within desktop flows.

Answer: ACD

NEW QUESTION 15

- (Exam Topic 3)  
You create a variable named NewVar as shown in the configuration screen below.



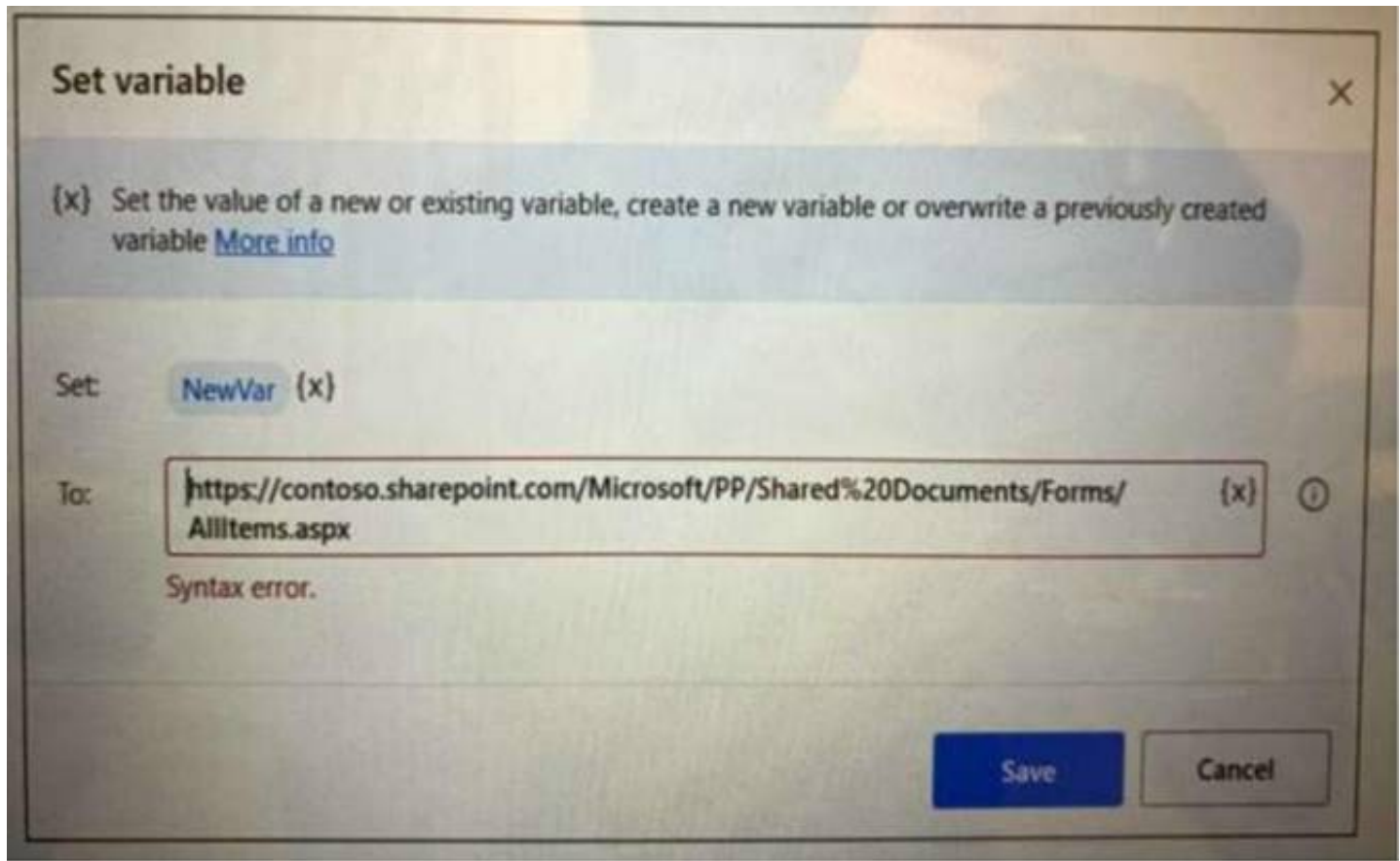

You attempt to set the value of NewVar to the following URL:

`https://contoso.sharepoint.com/Microsoft/PP/Shared%20Documents/Forms/AllItems.aspx`

The Set variable page alerts you that there is a syntax error. You need to resolve the issue. What should you do?

- A. Escape the percent sign (%) with a back slash (\%).
- B. Replace the percent sign (%) with two percent signs (%%).
- C. Replace the forward slash characters (/) with two forward slash characters (//).
- D. Escape the forward slash characters (/) with a back slash (\).

**Answer: D**

#### NEW QUESTION 16

- (Exam Topic 3)

A company publishes a list of contacts each day as an HTML table on a web page. The company has a customer relationship management (CRM) application that runs on employee desktop devices.

You need to implement an RPA solution that reads data from the HTML table and create records in the CRM application.

Which four actions should you perform in sequence? To answer, move the appropriate actions from the list of actions to the answer area and arrange them in the correct order.

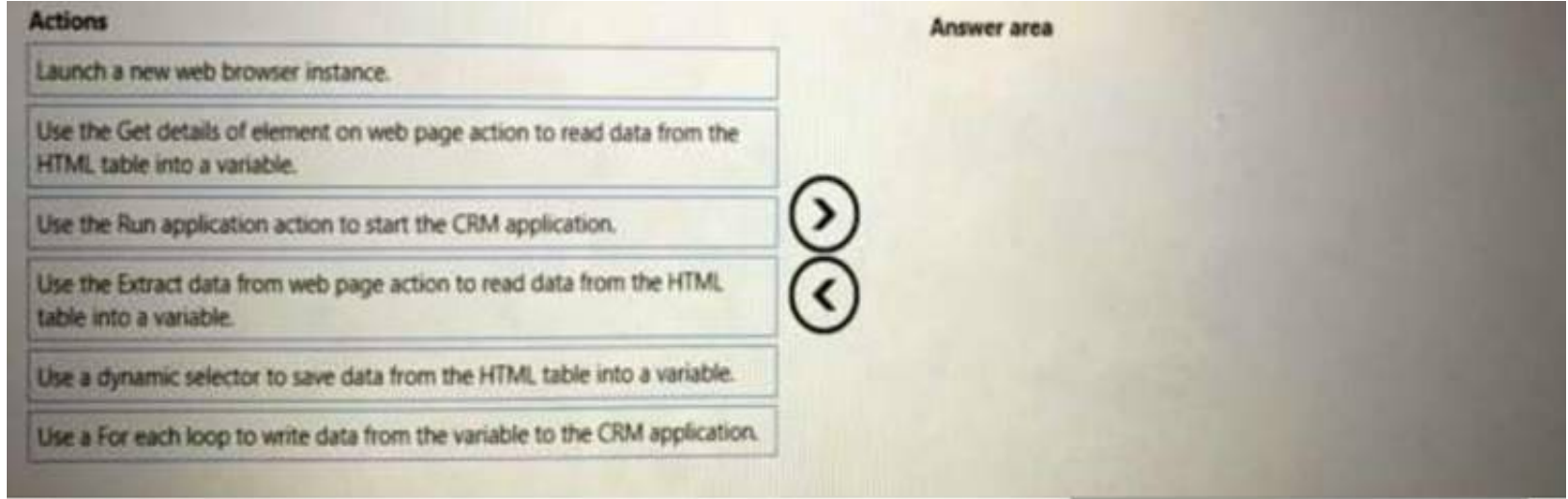

- A. Mastered
- B. Not Mastered

**Answer: A**

**Explanation:**

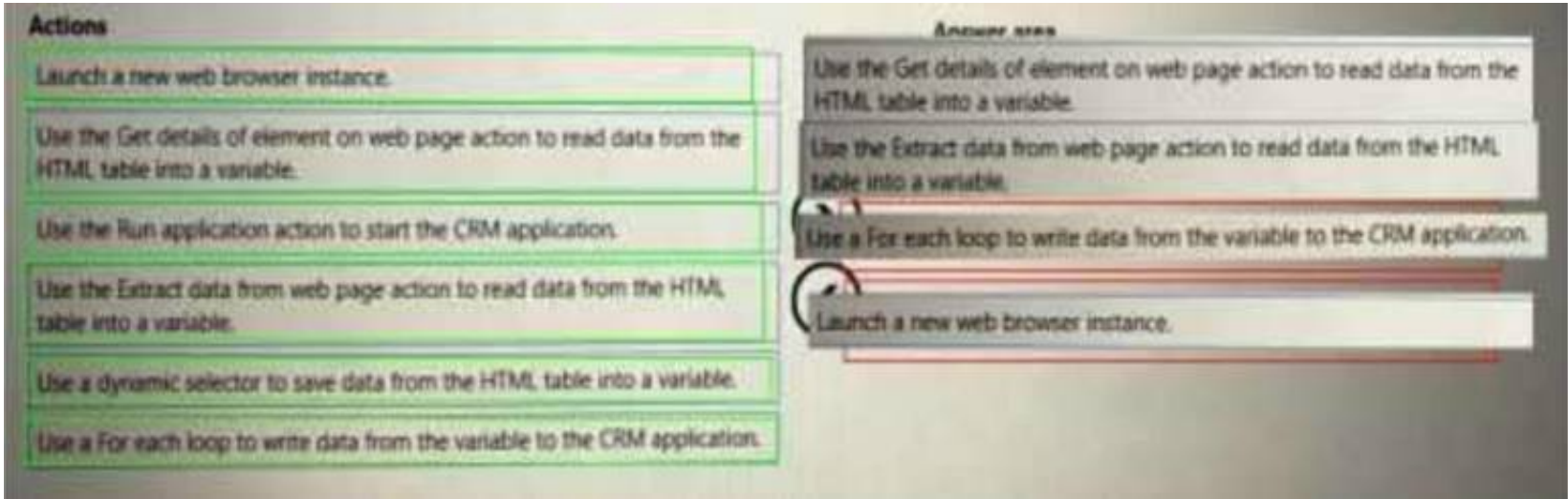

NEW QUESTION 18

- (Exam Topic 3)

You have a machine that runs an automation solution. You need to move the machine to a different environment.

Which three actions should you perform in sequence? To answer, move the appropriate actions from the list of actions to the answer area and arrange them in the coned order.

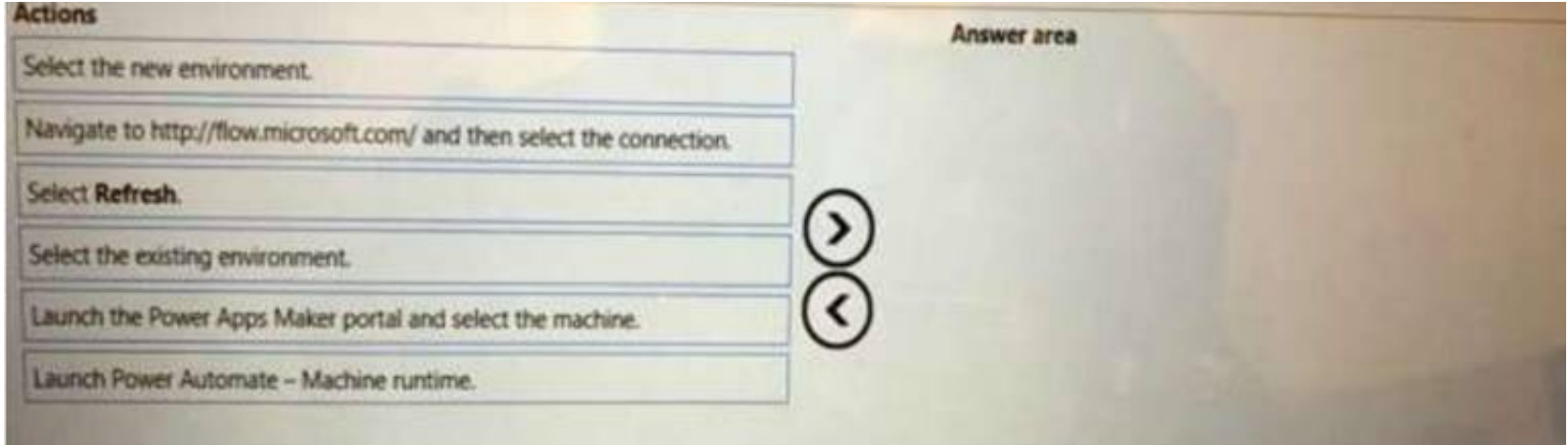

- A. Mastered
- B. Not Mastered

Answer: A

Explanation:

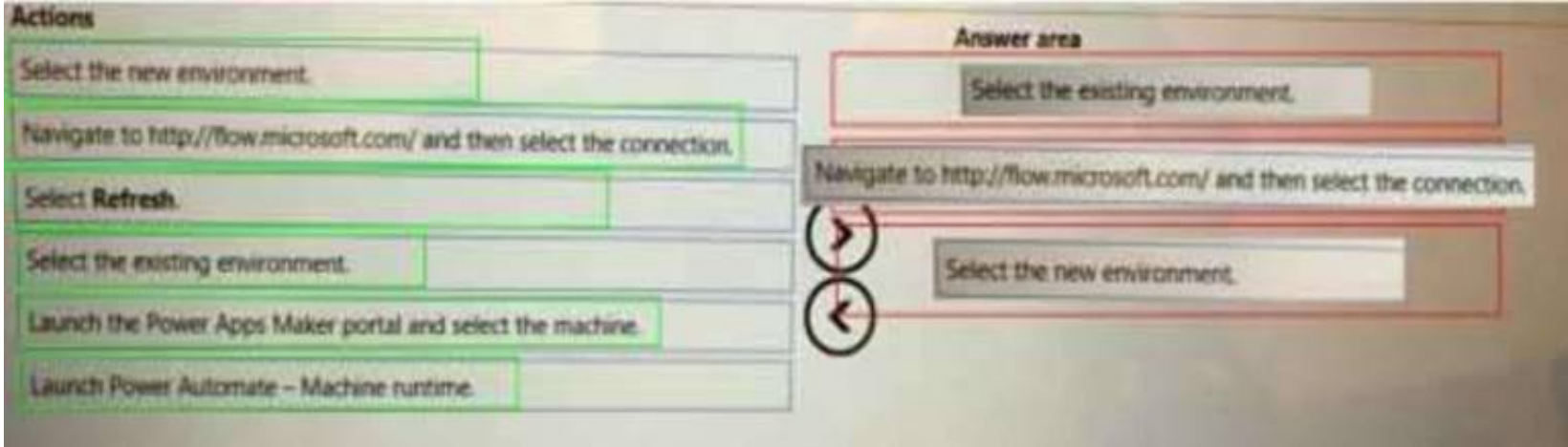

NEW QUESTION 21

- (Exam Topic 3)

You are creating a solution that will use a Choice field for approvals.

You need to ensure that other users can use the Choice field with their Microsoft Dataverse tables.

What should you use?

- A. Environment variable
- B. Local choice
- C. Global choice

Answer: C

NEW QUESTION 22

- (Exam Topic 3)

You develop a desktop flow for a company.

You need to ensure that another user can modify the flow.

Which three actions should you perform in sequence? To answer, move the appropriate actions from the order.



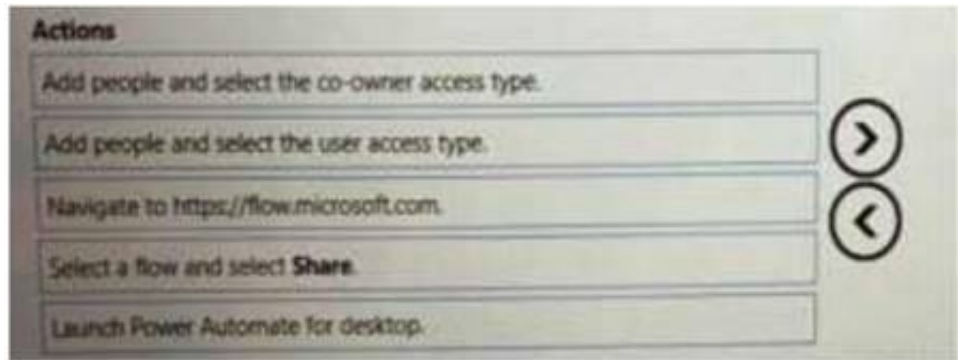

- A. Mastered
- B. Not Mastered

Answer: A

Explanation:

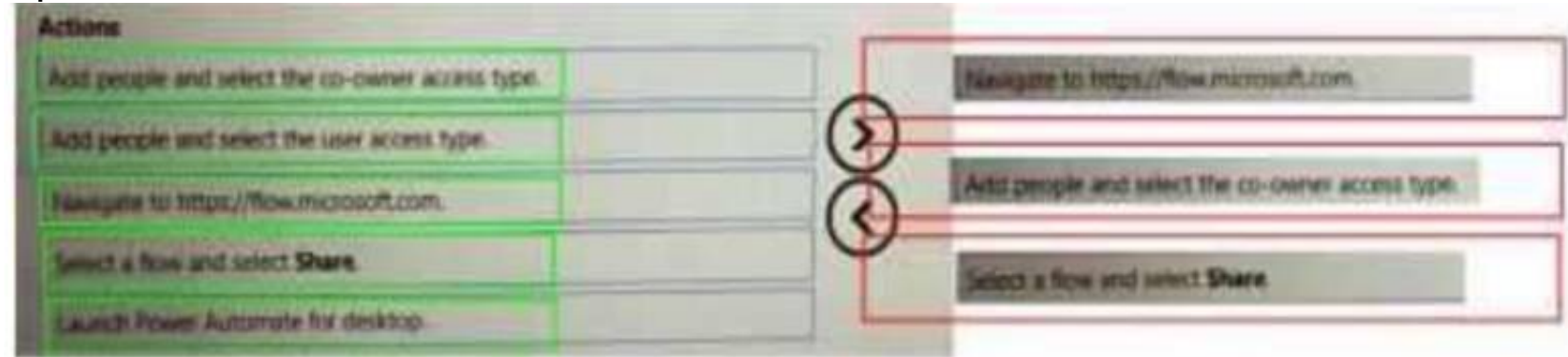

NEW QUESTION 25

- (Exam Topic 3)

You are developing a custom connector.

You need to create the definition for the connector.

Which features should you use? To answer, select the appropriate options in the answer area. NOTE: Each correct selection is worth one point.

Answer Area

Scenario	Feature
Define operations that users can perform.	<div>Code</div> <div>Action</div> <div>Policy</div> <div>Trigger</div>
Define actions that will be invoked by events.	<div>Code</div> <div>Action</div> <div>Policy</div> <div>Trigger</div>
Change the host URL for specific actions.	<div>Code</div> <div>Action</div> <div>Policy</div> <div>Trigger</div>
Extract data from responses by using regex expressions.	<div>Code</div> <div>Action</div> <div>Policy</div> <div>Trigger</div>

- A. Mastered
- B. Not Mastered

Answer: A

Explanation:

Scenario	Feature
Define operations that users can perform.	<div>Code</div> <div>Action</div> <div>Policy</div> <div>Trigger</div>
Define actions that will be invoked by events.	<div>Code</div> <div>Action</div> <div>Policy</div> <div>Trigger</div>
Change the host URL for specific actions.	<div>Code</div> <div>Action</div> <div>Policy</div> <div>Trigger</div>
Extract data from responses by using regex expressions.	<div>Code</div> <div>Action</div> <div>Policy</div> <div>Trigger</div>

NEW QUESTION 30  
- (Exam Topic 3)  
You create the following flow:

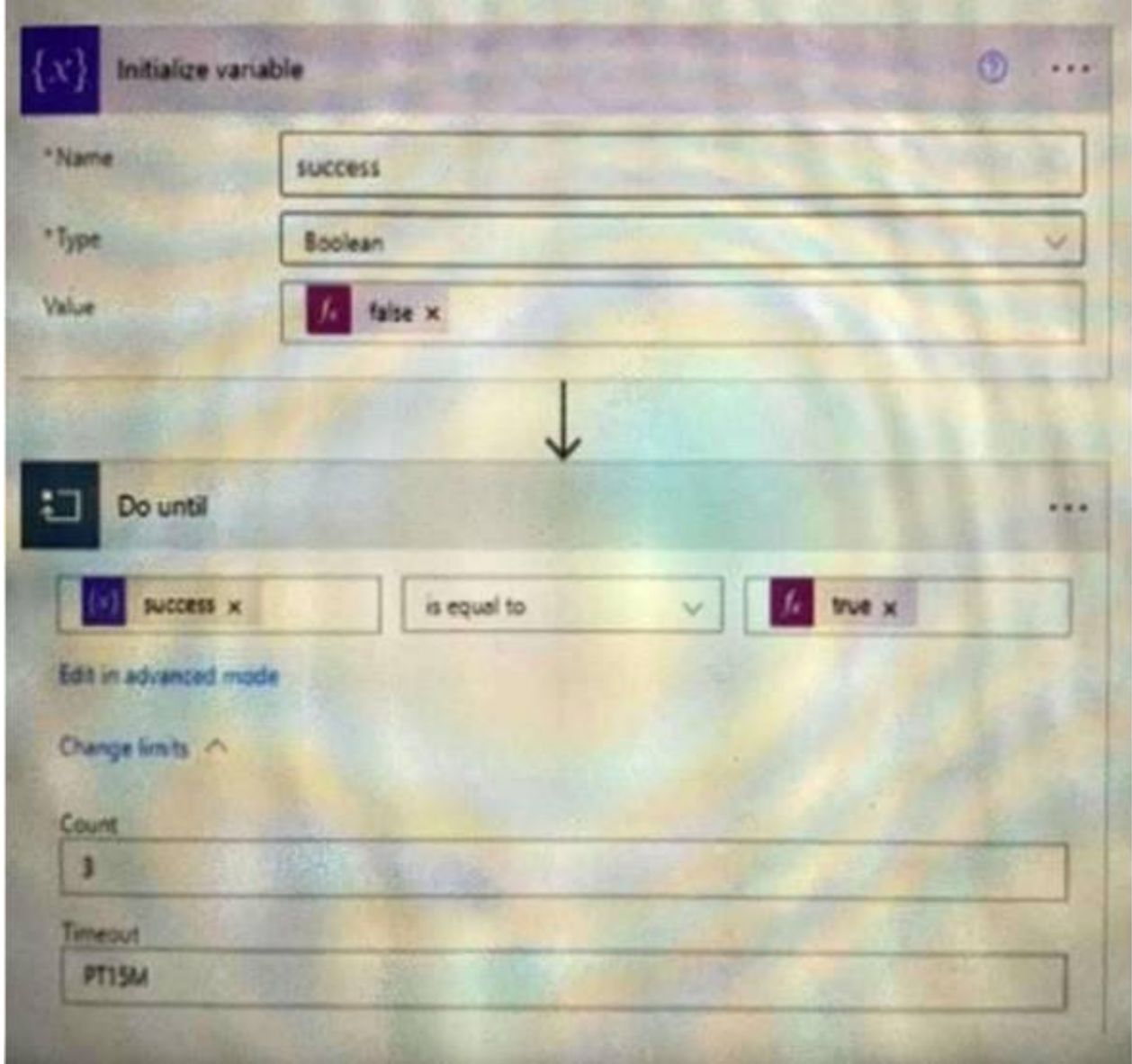

For each of the following statements, select Yes if the statement is true. Otherwise, select No. NOTE: Each correct selection is worth one point.

Questions	Response
What does the value 3 in the Count property represent?	<div>The do until action will retry up to three times if there are any failures.</div> <div>The do until actions must succeed three times before moving on to the next action.</div>
What does the value PT15M in the Timeout property represent?	<div>The do until must run for a minimum of 15 minutes.</div> <div>The flow cannot exceed 15 minutes of total run time.</div> <div>The do until will time out when it reaches 15 minutes.</div>

- A. Mastered
- B. Not Mastered

Answer: A



Explanation:

Questions	Response
What does the value 3 in the Count property represent?	<div>The do until action will retry up to three times if there are any failures. The do until actions must succeed three times before moving on to the next action.</div>
What does the value PT15M in the Timeout property represent?	<div>The do until must run for a minimum of 15 minutes. The flow cannot exceed 15 minutes of total run time. The do until will time out when it reaches 15 minutes.</div>

NEW QUESTION 31

- (Exam Topic 3)

A developer creates a desktop flow. You need to debug the flows.

Which debugging tools should you use? To answer, select the appropriate options in the answer area. NOTE: Each correct selection is worth one point.

Answer Area

Scenario	Debugging tool
Run each action and then pause the flow after the action completes. Open the variables pane to check a value before continuing the flow.	<div>Run delay Find in code Run from here Run next action</div>
Automatically stop the flow at a specific action.	<div>Pause Run delay Stop flow Breakpoint</div>
Define the time that the flow pauses after running each action.	<div>Run delay Run from here Run next action Wait for process</div>

- A. Mastered
- B. Not Mastered

Answer: A

Explanation:

Answer Area

Scenario	Debugging tool
Run each action and then pause the flow after the action completes. Open the variables pane to check a value before continuing the flow.	<div>Run delay Find in code Run from here Run next action</div>
Automatically stop the flow at a specific action.	<div>Pause Run delay Stop flow Breakpoint</div>
Define the time that the flow pauses after running each action.	<div>Run delay Run from here Run next action Wait for process</div>

NEW QUESTION 32

- (Exam Topic 3)

A company uses Microsoft 365 apps. You are building a flow that is triggered when a new email arrives.

If an email message contains a Microsoft Excel workbook attachment the solution must post the Excel data to an external customer relationship management (CRM) system that runs on a user's workstation. The CRM system is not accessible by using an API.

You need to design the solution.



Which three actions should you perform? Each correct answer presents part of the solution. NOTE: Each correct selection is worth one point.

- A. Implement the Create file action from the OneDrive connector in a cloud flow.
- B. Create a desktop flow.
- C. Implement the When a new email arrives trigger in a cloud flow.
- D. Implement the Retrieve email messages action from a desktop flow.
- E. Create a desktop flow and define an input variable of type file.

Answer: ACE

NEW QUESTION 37

- (Exam Topic 3)

You are developing automation solutions for a company.

You plan to use Process advisor to gain a better understanding of business processes. You need to select the process types to use to meet the company's requirements.

Which process types should you use? To answer, drag the appropriate process types to the correct requirements. Each process type may be used once, more than once, or not at all. You may need to drag the split bar between panes or scroll to view content.

NOTE: Each correct selection is worth one point.

Process types		Requirement	Process type
Process mining		Identify and eliminate unnecessary process tasks.	Process type
Task mining		Reduce total process time.	Process type
		Automate tasks that will accelerate processes and reduce human error.	Process type

- A. Mastered
- B. Not Mastered

Answer: A

Explanation:

Process types		Requirement	Process type
Process mining		Identify and eliminate unnecessary process tasks.	Task mining
Task mining		Reduce total process time.	Task mining
		Automate tasks that will accelerate processes and reduce human error.	Process mining

NEW QUESTION 42

- (Exam Topic 3)

You create the following flows:

1

Get current date and time

Retrieve the current datetime and store it into `CurrentDateTime`

2

Launch new Microsoft Edge

Launch Microsoft Edge, navigate to `'https://www.google.ca/?gws_rd=ssl'` and store the instance info `Browser`

3

Launch Excel

Launch Excel with a blank document using an existing excel process

4

Get active Excel worksheet

Get the name and index of the active worksheet of the Excel document in instance `ExcelInstance`

5

Launch Excel

Launch Excel with a blank document using an existing excel process

6

Focus window

Focus window with title `"Microsoft Edge"`

7

Set window state

Set the state of window with title `"Microsoft Edge"` to `Maximized`

8

Get active Excel worksheet

Get the name and index of the active worksheet of the Excel document in instance `ExcelInstance2`

9

Send keys

Send the following keystrokes: `"Control+X"` to the foreground window

Answer Area

Questions

Which line contains a breakpoint?

To which window does the action at step 9 send keystrokes?

Response

1

2

3

4

5

the Edge window launched in step 2

the Excel instance launched in step 3

the Excel instance launched in step 4

- A. Mastered
- B. Not Mastered

Answer: A

Explanation:

Answer Area

Questions

Which line contains a breakpoint?

To which window does the action at step 9 send keystrokes?

Response

1

2

3

4

5

the Edge window launched in step 2

the Excel instance launched in step 3

the Excel instance launched in step 4

NEW QUESTION 47

- (Exam Topic 3)  
You have a flow that interacts with different SharePoint sites. You add the flow to a solution.

You redeploy the solution to production each time you make a change to the flow. You do not want to change the SharePoint site URL every time you redeploy the solution.

You need to configure the solution. Which solution component should you use?

- A. Environment variable
- B. Web resource
- C. Managed identity
- D. Connection reference



Answer: D

NEW QUESTION 51

- (Exam Topic 3)

You are developing a solution for a medical practice. The solution must use an artificial intelligence (AI) model to evaluate medical X-ray images and detect broken bones.

You need to create the AI model for the solution. Solution: Use Azure Computer Vision to create the model. Does the solution meet the goal?

- A. Yes
- B. No

Answer: B

NEW QUESTION 53

- (Exam Topic 3)

You create a Microsoft Power Platform solution. You create variables to define input values for the flow. You export the solution as managed and import the solution into a user acceptance testing (UAT) environment.

The flow in the UAT environment is still using the values from the development (DEV) environment.

You need to resolve the issue.

Which four actions should you perform in sequence? To answer, move the appropriate actions from the list of actions to the answer area and arrange them in the correct order.

Actions

Turn the flow off and then on again.

Select Current value and then select Remove from this solution.

Delete the solution from the UAT environment.

Export and reimport the solution.

Select Current value and then select Remove from environment.

In the UAT environment, navigate to the solution and edit the details for each environment variable.

In the DEV environment, navigate to the solution and edit the details for each environment variable.

Answer Area

>

<

- A. Mastered
- B. Not Mastered

Answer: A

Explanation:

Actions

Turn the flow off and then on again.

Select Current value and then select Remove from this solution.

Delete the solution from the UAT environment.

Export and reimport the solution.

Select Current value and then select Remove from environment.

In the UAT environment, navigate to the solution and edit the details for each environment variable.

In the DEV environment, navigate to the solution and edit the details for each environment variable.

Answer Area

Select Current value and then select Remove from environment.

Turn the flow off and then on again.

Delete the solution from the UAT environment.

In the DEV environment, navigate to the solution and edit the details for each environment variable.

NEW QUESTION 54

- (Exam Topic 3)

You develop Power Automate flows for a company. You need to help users locate and run the flows. Where should you direct users to find the flows? To answer NOTE: Each correct selection is worth one point.

Answer Area

Requirement

You select the **Send a copy** button from the flow portal to send the flow to a business user group.

You select the **Share** button from the portal to share the flow with business users.

Value

the Solutions page

the Shared with me tab of the My flows page

the Shared with me tab of the Templates page

the Solutions page

the Shared with me tab of the My flows page

the Shared with me tab of the Templates page



- A. Mastered
- B. Not Mastered

Answer: A

Explanation:

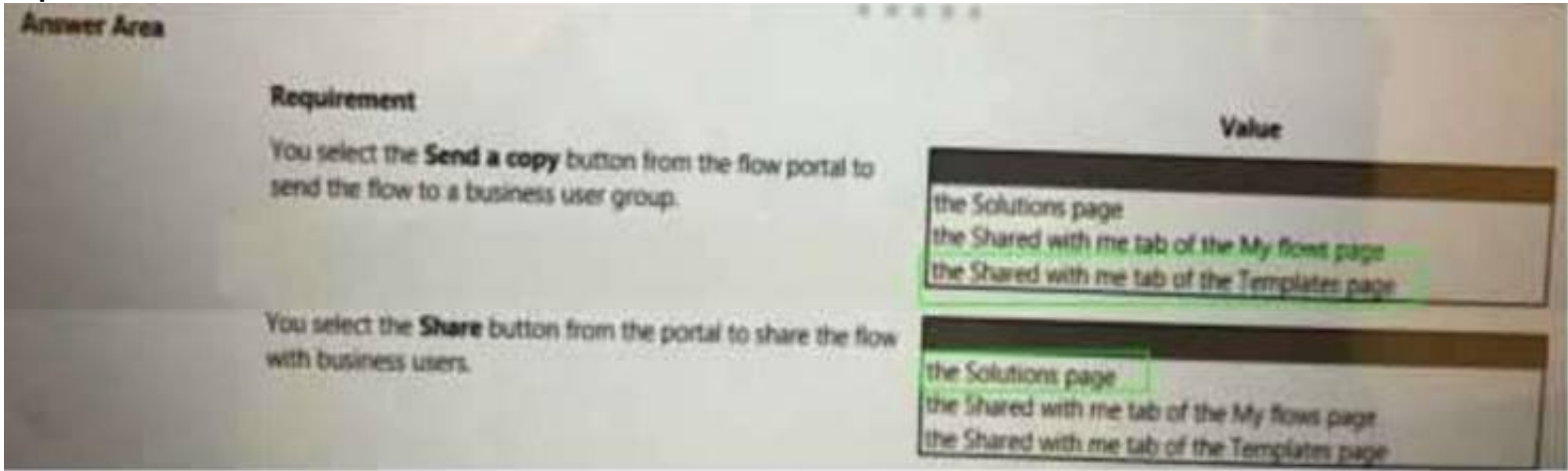

NEW QUESTION 56

- (Exam Topic 3)

You are developing desktop flows for a company.

You need to use Recorder to record steps that you are performing in target applications.

Which recording modes will Recorder use? To answer, drag the appropriate recording modes to the correct target applications. Each recording mode may be used once, more than once, or not at all. You may need to drag the split bar between panes or scroll to view content.

NOTE: Each correct selection is worth one point.



- A. Mastered
- B. Not Mastered

Answer: A

Explanation:

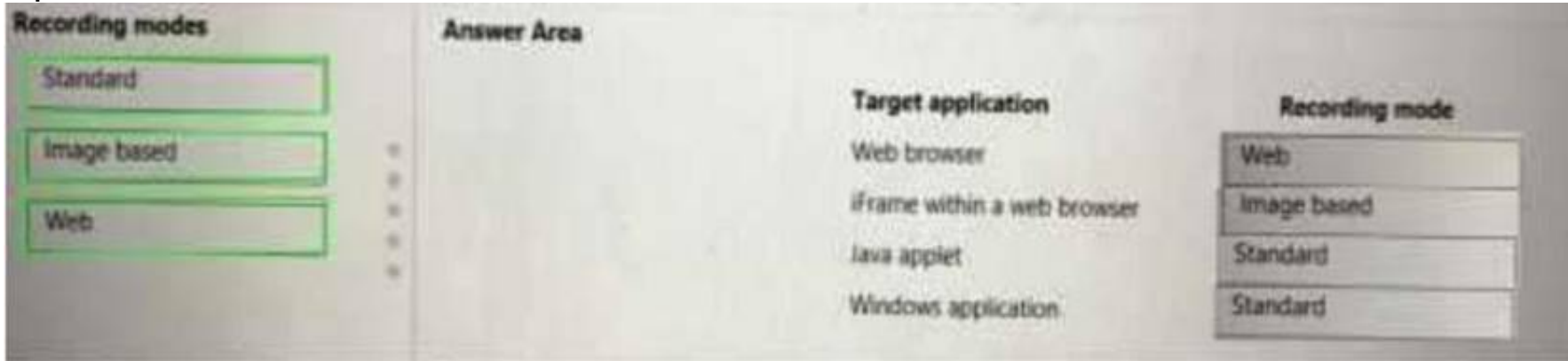

NEW QUESTION 57

- (Exam Topic 3)

You are creating a cloud flow that will use two Update Row actions to interact with Microsoft Dataverse. Neither of these actions are dependent on each other. You must minimize the amount of processing time required to complete the flow. You need to implement the actions in the cloud flow.

Solution: Create a do until loop. Does the solution meet the goal?

- A. Yes
- B. No

Answer: A

NEW QUESTION 59

- (Exam Topic 3)

You develop a desktop flow. The flow performs five actions in sequence.

If an error occurs, you must restart the flow from the first action. You add the five actions to an On block error action.

You need to configure error handling.

Which two actions should you perform? Each correct answer presents part of the solution. NOTE: Each correct selection is worth one point.

- A. Change the exception handling mode to Go to the beginning of the block.
- B. Select Continue flow run.
- C. Select Throw error.
- D. Change the exception handling mode to Go to next action.
- E. Configure an On error condition for the first action.

**Answer:** ACE

#### NEW QUESTION 62

- (Exam Topic 3)

You create several desktop flows. Each flow will run on a single user's device. You need to determine how Power Automate will orchestrate the flows. Which three rules will Power Automate apply? Each correct answer presents a complete solution. NOTE: Each correct selection is worth one point.

- A. All the flows are run simultaneously.
- B. The next flow will run when each run completes based on the priority and the time requested.
- C. The first flow runs on the target device based on the priority and the time requested.
- D. The first flow runs on the target device based on Next to run status and time requested.
- E. The first and last flows run based on the priority and the time requested.
- F. The remaining flows are queued.

**Answer:** AEF

#### NEW QUESTION 63

- (Exam Topic 3)

You must create new flows within a solution and import existing flows into the solution. You need to configure the solution.

Which three actions can you perform? Each correct answer presents a complete solution. NOTE: Each correct selection is worth one point.

- A. Create the flows within the solution to automatically create connection references.
- B. Add credential information to each connection reference.
- C. Modify each trigger and action when you add a flow into the solution to use connection references
- D. Select connections for connection references when you import solutions into an environment
- E. Add an existing connection reference into the solution in the same environment.

**Answer:** ADE

#### NEW QUESTION 64

- (Exam Topic 3)

You are developing a cloud flow.

You write expressions for the following JSON object. (Line numbers are included for reference only.)

```
01 {  
02     "customerNumber": 10091,  
03     "customerPhones": [  
04         "011-2345213",  
05         "0114456129"  
06     ]  
07 }
```

The flow parses JSON data by using the following schema;

```
09 {
10   "type": "object",
11   "properties": {
12     "customerName": {
13       "type": [
14         "string",
15         "null"
16       ]
17     },
18     "customerNumber": {
19       "type": "integer"
20     },
21     "customerPhones": {
22       "type": "array",
23       "minItems": 1,
24       "items": {
25         "type": "string"
26       }
27     }
28   }
29 }
```

For each of the following statements, select Yes if the statement is true. Otherwise, select No. NOTE: Each correct selection is worth one point.

Answer Area

Statements	Yes	No
The expression <code>empty(body('Parse_JSON')['customerName'])</code> returns true.	<input type="radio"/>	<input type="radio"/>
The expression <code>concat(body('Parse_JSON').customerName, ': ', body('Parse_JSON').customerNumber)</code> returns 10091.	<input type="radio"/>	<input type="radio"/>
The expression <code>equals(body('Parse_JSON')?.customerPhones[2], '')</code> returns true.	<input type="radio"/>	<input type="radio"/>
The expression <code>int(body('Parse_JSON')?['customerPhones']?[1])</code> returns 114456129.	<input type="radio"/>	<input type="radio"/>

- A. Mastered
- B. Not Mastered

Answer: A

Explanation:

Answer Area

Statements	Yes	No
The expression <code>empty(body('Parse_JSON')['customerName'])</code> returns true.	<input checked="" type="radio"/>	<input type="radio"/>
The expression <code>concat(body('Parse_JSON').customerName, ': ', body('Parse_JSON').customerNumber)</code> returns 10091.	<input checked="" type="radio"/>	<input type="radio"/>
The expression <code>equals(body('Parse_JSON')?.customerPhones[2], '')</code> returns true.	<input checked="" type="radio"/>	<input type="radio"/>
The expression <code>int(body('Parse_JSON')?['customerPhones']?[1])</code> returns 114456129.	<input type="radio"/>	<input checked="" type="radio"/>

NEW QUESTION 65

- (Exam Topic 3)

A company has a customer relationship management (CRM) app installed on a machine.

Each month an employee signs into the machine by using their Azure Active Directory (Azure AD) account to generate a financial statement for each account in a



list of accounts. The list of accounts is stored in Microsoft Dataverse. The employee must send each customer their statements by using Office 365 Outlook. You need to develop a solution to automate the task. Which components should you use? To answer, select the appropriate options in the answer area.

Requirement

Trigger the solution using a schedule.

Access the list of accounts.

Launch the CRM app.

Generate a statement for each account.

Send an email with an attachment.

Action

Create a cloud flow that uses a manual trigger.  
Create a cloud flow that uses a schedule trigger.  
Create a desktop flow and use Windows Task Scheduler to trigger it.  
Create a desktop flow and trigger it manually.

Use the Relate rows action in a cloud flow.  
Use the List rows action in a cloud flow.  
Use the List rows present in a table action in a cloud flow.  
Use the Get a row action in a cloud flow.

Use the Start service action in a desktop flow.  
Use the Run application action in a desktop flow.  
Use the Run a flow built with Power Automate for desktop action in a cloud flow.  
Use the Run desktop flow action in a desktop flow.

Use the Apply to each action in a cloud flow.  
Use the For each action in a desktop flow.  
Use the Next loop action in a desktop flow.  
Use the Go to action in a desktop flow.

Use the Send email action in a desktop flow.  
Use the Send an email action in a cloud flow.  
Use the Send Exchange email message action in a desktop flow.  
Use the Send email message through Outlook action in a desktop flow.

- A. Mastered
- B. Not Mastered

Answer: A

Explanation:

Requirement

Trigger the solution using a schedule.

Access the list of accounts.

Launch the CRM app.

Generate a statement for each account.

Send an email with an attachment.

Action

Create a cloud flow that uses a manual trigger.  
Create a cloud flow that uses a schedule trigger.  
Create a desktop flow and use Windows Task Scheduler to trigger it.  
Create a desktop flow and trigger it manually.

Use the Relate rows action in a cloud flow.  
Use the List rows action in a cloud flow.  
Use the List rows present in a table action in a cloud flow.  
Use the Get a row action in a cloud flow.

Use the Start service action in a desktop flow.  
Use the Run application action in a desktop flow.  
Use the Run a flow built with Power Automate for desktop action in a cloud flow.  
Use the Run desktop flow action in a desktop flow.

Use the Apply to each action in a cloud flow.  
Use the For each action in a desktop flow.  
Use the Next loop action in a desktop flow.  
Use the Go to action in a desktop flow.

Use the Send email action in a desktop flow.  
Use the Send an email action in a cloud flow.  
Use the Send Exchange email message action in a desktop flow.  
Use the Send email message through Outlook action in a desktop flow.

NEW QUESTION 67

- (Exam Topic 3)  
You plan to use a cloud flow.  
The flow must be contained within a solution. You need to add the cloud flow to a solution.  
Solution: Create an instant cloud flow outside of a solution. Add the cloud flow into a new unmanaged solution. Does the solution meet the goal?

- A. Yes
- B. No

Answer: A

NEW QUESTION 72

- (Exam Topic 3)  
A company hires you to develop a solution that helps the company manage new hires. Users will enter information about the new employee into an app and the app will save the information to a database.

The app must be simple to use and must rely on a data model. You must implement a workflow that automatically notifies the IT department when new employee records are created in the database.  
You need to create the solution.  
Which three actions should you perform in sequence? To answer, move the appropriate actions from the list of actions to the answer area and arrange them in the correct order.

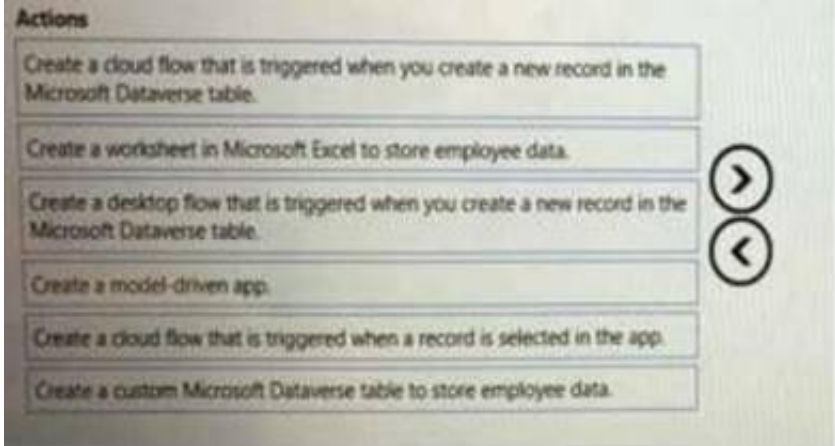

- A. Mastered
- B. Not Mastered

Answer: A

Explanation:

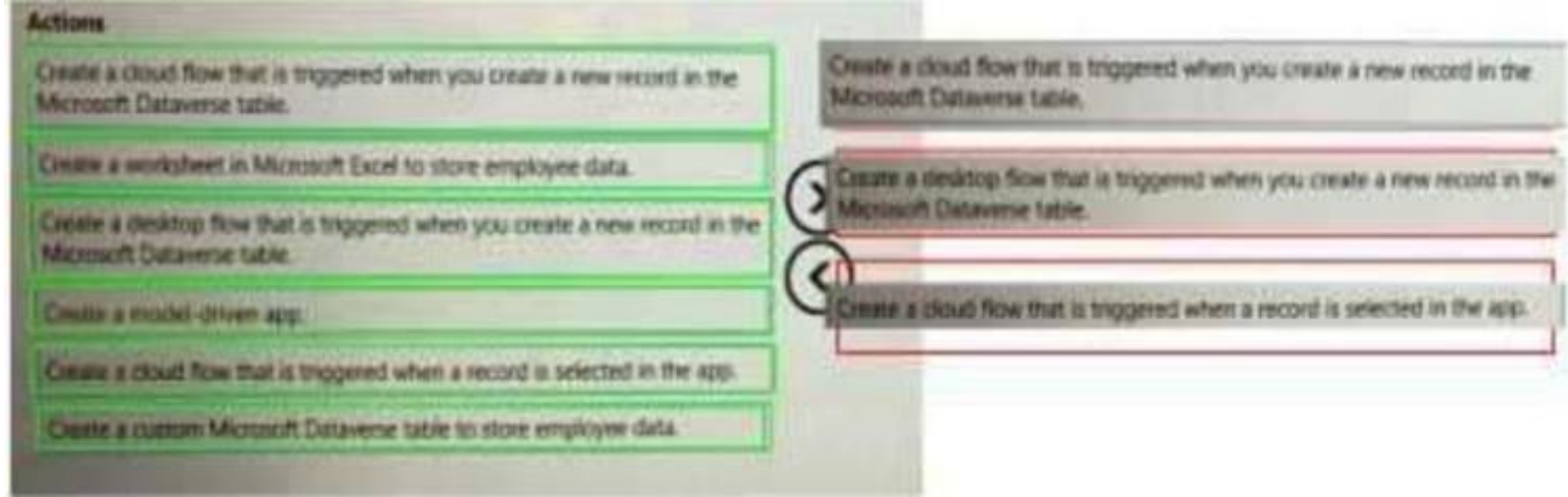

NEW QUESTION 74

- (Exam Topic 3)  
You have a Microsoft Dataverse table in a solution. You delete fields from the table.  
You need to automatically delete the fields from the Microsoft Dataverse table when you import the updated solution into a target environment.  
Which import option should you use?

- A. Stage for upgrade
- B. Update
- C. Upgrade

Answer: C

NEW QUESTION 79

- (Exam Topic 3)  
You are developing automation solutions for a company.  
You need to select the components to use for each scenario. You must minimize development efforts. Which methods should you use? To answer, select the appropriate options in the answer area.  
NOTE: Each correct selection is worth one point.

Answer Area	
Scenario	Component
Query items from a SharePoint list.	<div>Built-in connector</div> <div>Custom connector</div> <div>HTTP connector</div> <div>Azure API Management</div>
Share methods from a third-party REST API with an organization.	<div>Built-in connector</div> <div>Custom connector</div> <div>HTTP connector</div> <div>Browser automation</div>
Call a Microsoft Graph API endpoint using application permissions.	<div>Built-in connector</div> <div>Custom connector</div> <div>HTTP connector</div> <div>Azure API Management</div>



- A. Mastered
- B. Not Mastered

Answer: A

Explanation:

Scenario	Component
Query items from a SharePoint list.	Built-in connector Custom connector HTTP connector Azure API Management
Share methods from a third-party REST API with an organization.	Built-in connector Custom connector HTTP connector Browser automation
Call a Microsoft Graph API endpoint using application permissions.	Built-in connector Custom connector HTTP connector Azure API Management

NEW QUESTION 80

- (Exam Topic 3)

You have a desktop flow that interacts with a desktop-based application. You plan to enter data into each field by using the Send keys action. You test the flow. The Send keys action runs successfully but the input fields are empty. You need to add a step before the Send keys action to resolve the issue. Which two steps can you use? Each correct answer presents a complete solution. NOTE: Each correct selection is worth one point.

- A. Use the Wait for window action.
- B. Set the key state.
- C. Use the Focus window action.
- D. Set the window state.
- E. Use the Wait for mouse action

Answer: DE

NEW QUESTION 85

- (Exam Topic 3)

A company has a customer relationship management (CRM) application that runs on a virtual machine (VM) in Azure. The solution must automatically extract common invoice data from documents sent as email attachments and save the data to the company's CRM application. You need to design the solution. In which order should you perform the actions? To answer, move all actions from the list of actions to the answer area and arrange them in the correct order.

Actions	Answer Area
Define input variables in the desktop flow.	
Create an instance of the Invoice processing AI Builder model.	
Define the logic in the desktop flow to write data to the CRM.	
Create a cloud flow that extracts information from the model and triggers the desktop flow.	
Create a desktop flow.	

- A. Mastered
- B. Not Mastered

Answer: A

Explanation:

Actions	Answer Area
Define input variables in the desktop flow.	Create a desktop flow.
Create an instance of the Invoice processing AI Builder model.	Define the logic in the desktop flow to write data to the CRM.
Define the logic in the desktop flow to write data to the CRM.	Define input variables in the desktop flow.
Create a cloud flow that extracts information from the model and triggers the desktop flow.	Create an instance of the Invoice processing AI Builder model.
Create a desktop flow.	Create a cloud flow that extracts information from the model and triggers the desktop flow.



NEW QUESTION 88

- (Exam Topic 3)

A company has a business-critical desktop flow that runs on a single machine. The number of daily runs for the flow has significantly increased recently. Users report that the time required for the flow to complete is no longer acceptable. You need to scale the solution. Which four actions should you perform in sequence? To answer, move the appropriate actions from the list of actions to the answer area and arrange them in the correct order.

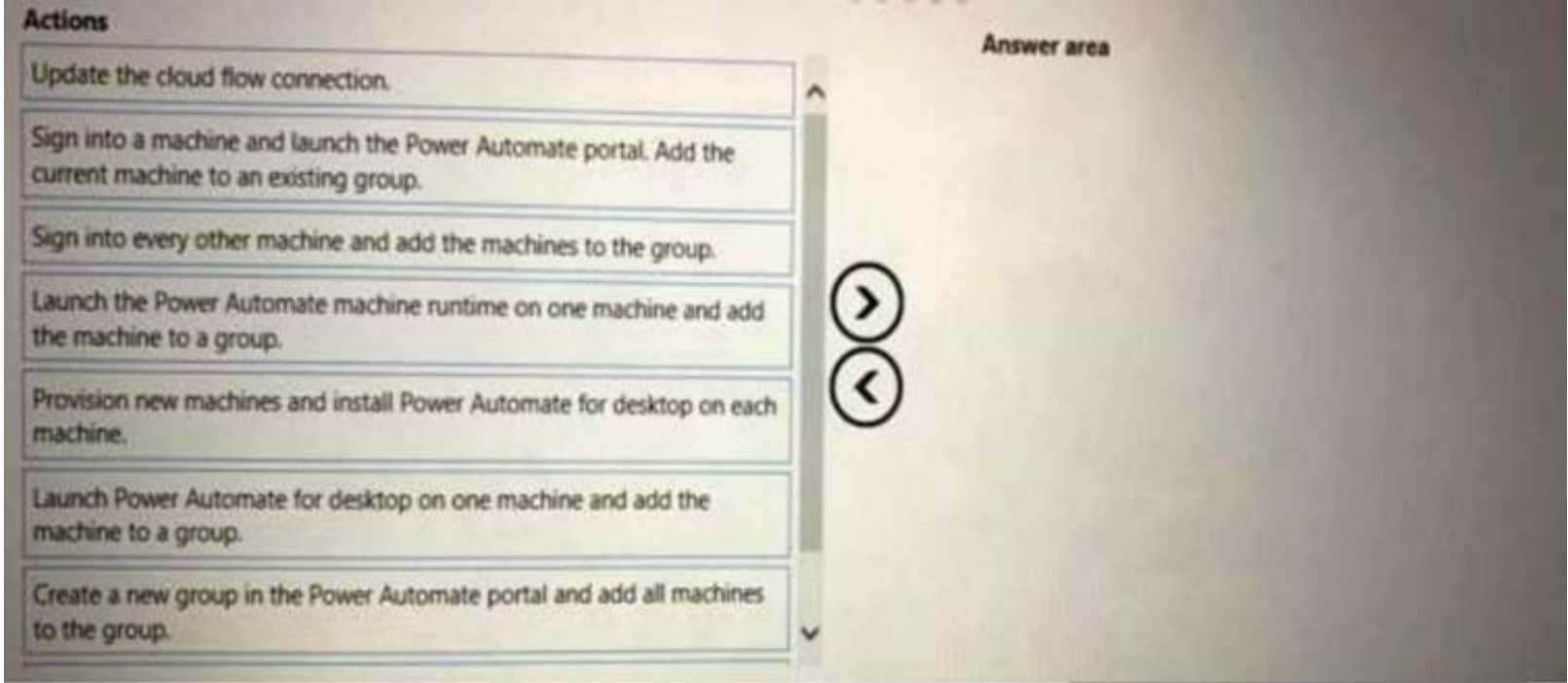

- A. Mastered
- B. Not Mastered

Answer: A

Explanation:

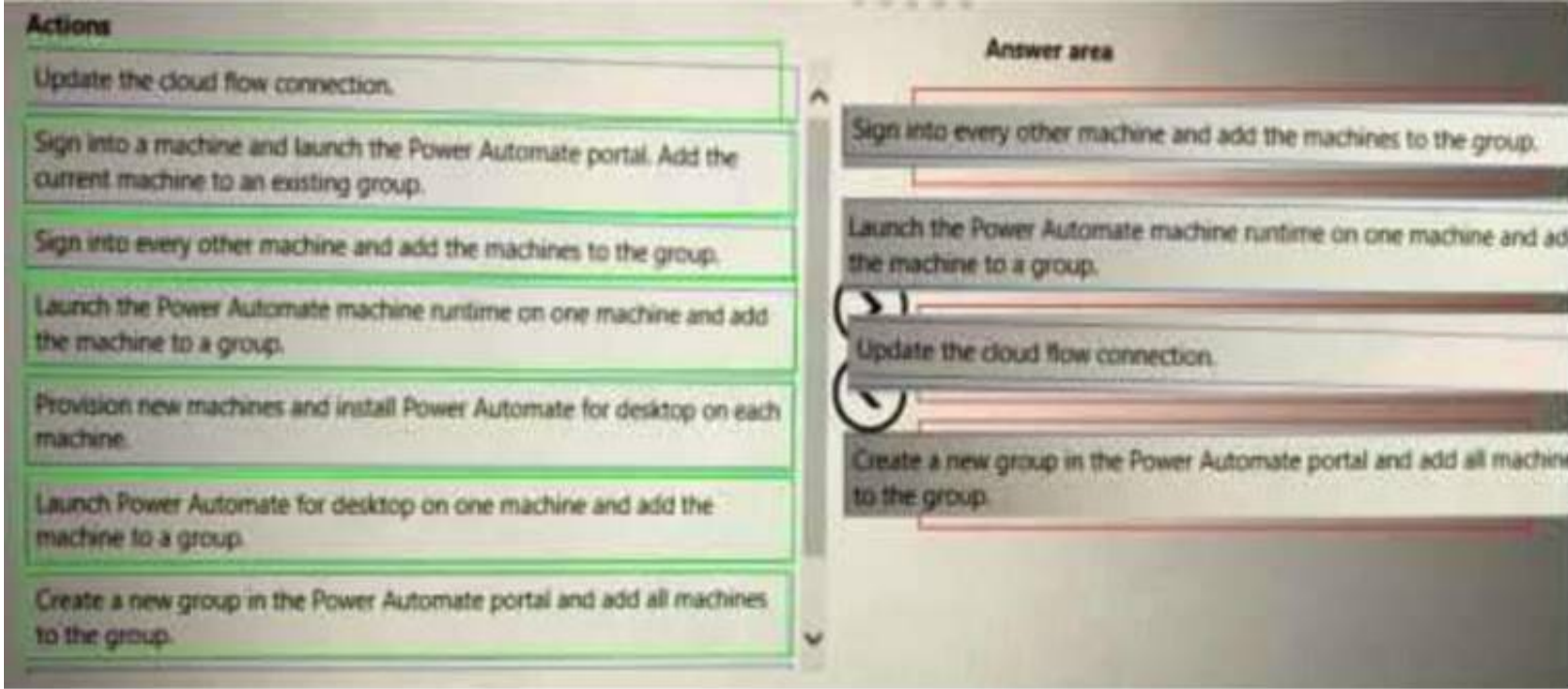

NEW QUESTION 90

- (Exam Topic 3)

You are editing a cloud flow in the Power Automate flow designer. You need to resubmit the most recent trigger.

Which five actions should you perform in sequence? To answer, move the appropriate actions from the list of actions to the answer area and arrange them in the correct order.

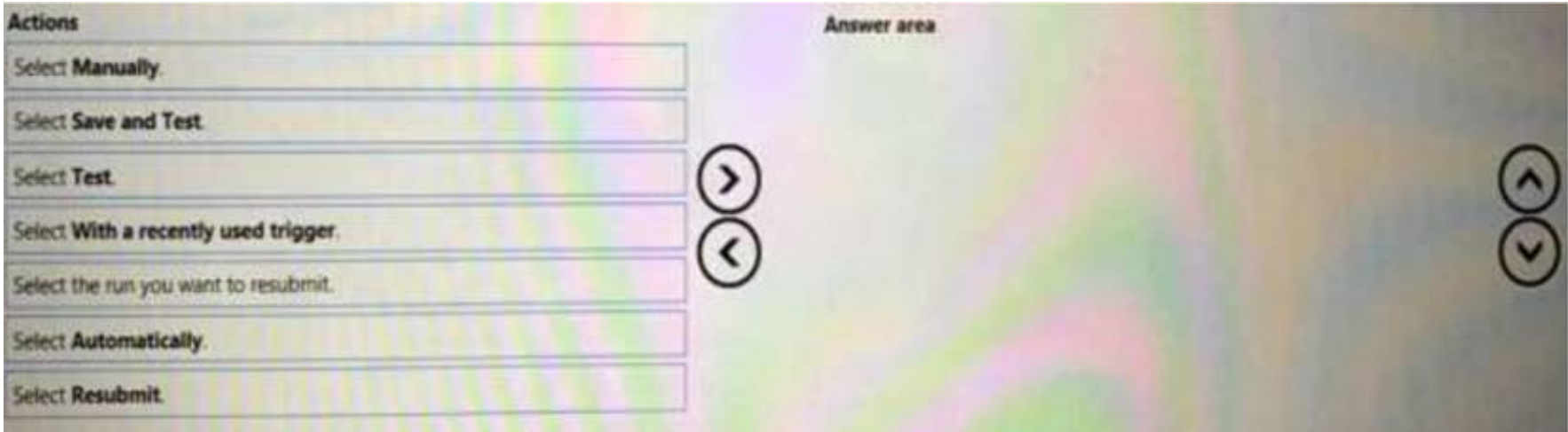

- A. Mastered
- B. Not Mastered

**Answer:** A

**Explanation:**

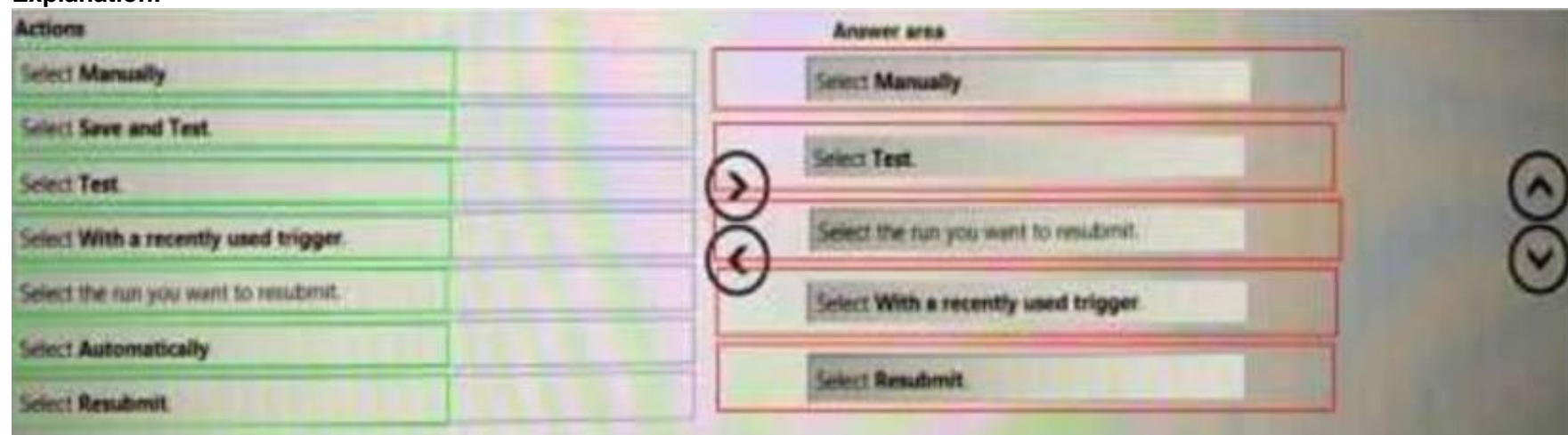

#### NEW QUESTION 92

- (Exam Topic 3)

You are developing an RPA solution that requires browser automation. You are testing the flow. You observe that the flow does not interact with web page elements in Microsoft Edge. You need to troubleshoot the issue. What should you do?

- A. Enable error handling on the action to retry on failure.
- B. Ensure the UI flows/Selenium extension is downloaded and enabled in Microsoft Edge.
- C. Open Power Automate machine runtime and select Troubleshoot
- D. Ensure the Power Automate for desktop browser extension is downloaded and enabled in Microsoft Edge.

**Answer:** A

#### NEW QUESTION 97

- (Exam Topic 3)

You develop a Microsoft Power Platform solution for a client.

You must test the solution in a user acceptance testing (UAT) environment before deploying the solution to production. You must ensure that the configurations for the UAT and production environments are identical. You must minimize administrative effort.

You need to ensure that the environments are identical. Which Microsoft Power Platform feature should you use?

- A. Copy environment
- B. Edit environment properties
- C. Move environment
- D. Reset environment
- E. Restore environment

**Answer:** AB

#### NEW QUESTION 102

- (Exam Topic 3)

You create an unattended Office 365 automation. The automation stops running.

You suspect that the runtime identity used by the automation caused the automation to stop running. Which two issues can the runtime identity cause in this scenario? Each correct answer presents a complete solution. NOTE: Each correct selection is worth one point.

- A. The automation is attempting to open files that cannot be opened or edited based on per-user access permissions
- B. The automation is not set up to handle an additional sign-in UI element.
- C. The unattended automation process suppressed an alert that was generated.
- D. The location of a specific user interface element has changed.

**Answer:** BD

#### NEW QUESTION 103

- (Exam Topic 3)

You are designing automation solutions that interact with a desktop application.

You need to select the appropriate UI automation action for each business requirement.

Which automation action should you use? To answer, select the appropriate options in the answer area. NOTE: Each correct selection is worth one point.



Requirement	UI automation action
Retrieve the state from a checkbox in the desktop application.	Get selected checkboxes in window Get details of a UI element in window Get selected radio button in window Extract data from window
Bring the desktop application to the foreground.	Focus window Get details of window Get details of a UI element in window Set window state
Suspend a process until a specific window opens.	Wait for window Wait for window content Set window state Terminate process

- A. Mastered
- B. Not Mastered

Answer: A

Explanation:

Requirement	UI automation action
Retrieve the state from a checkbox in the desktop application.	Get selected checkboxes in window Get details of a UI element in window Get selected radio button in window Extract data from window
Bring the desktop application to the foreground.	Focus window Get details of window Get details of a UI element in window Set window state
Suspend a process until a specific window opens.	Wait for window Wait for window content Set window state Terminate process

NEW QUESTION 104

- (Exam Topic 3)

You are developing a desktop flow.

You need to include an IF statement that contains AND logic within the flow. Which expression should you use for the IF statement?

A)

```
IF $'' '%IsEmpty(Variable1)% AND %IsEmpty(Variable2)%'' = $'''True'''
```

B)

```
IF IsEmpty(IsEmpty(Variable1) AND IsEmpty(Variable2))
```

C)

```
IF IsEmpty(Variable1 AND Variable2)
```

D)

```
IF (IsEmpty(Variable1) OR IsEmpty(Variable2)) = $'''True'''
```

E)

```
IF (IsEmpty(Variable1) AND IsEmpty(Variable2)) = $'''True'''
```

- A. Option A
- B. Option B
- C. Option C



D. Option D

Answer: C

NEW QUESTION 106

- (Exam Topic 3)

You are developing automation solutions for a company.

You need to select the applicable flow type to automate the following tools and technologies:

- Microsoft Excel
- Desktop application
- File system

Which flow types should you use? To answer, drag the appropriate flow types to the correct automation targets. Each flow type may be used once, more than once, or not at all. You may need to drag the split bar between panes or scroll to view content.

NOTE: Each correct selection is worth one point.

Flow types

Cloud flows only

Desktop flows only

Cloud flows or desktop flows

Answer Area

Automation target

Microsoft Excel

Desktop application

File system

Flow type

Flow type

Flow type

Flow type

- A. Mastered  
B. Not Mastered

Answer: A

Explanation:

Flow types

Cloud flows only

Desktop flows only

Cloud flows or desktop flows

Answer Area

Automation target

Microsoft Excel

Desktop application

File system

Flow type

Cloud flows only

Cloud flows or desktop flows

Desktop flows only

NEW QUESTION 109

- (Exam Topic 3)

You create a solution within a Microsoft Power Platform environment. The environment includes all connections required for the solution.

You need to create a connection reference for the flows.

Which four actions should you perform in sequence? To answer, move the appropriate actions from the list of actions to the answer area and arrange them in the order.

Actions

Within the solution, select Add Existing and then connection references.

Within the solution, select New and then connection references.

Assign the connection reference to the relevant desktop flows within the solution.

Create a new connection for the connection reference.

Use the connection reference in the relevant cloud flows within the solution.

Assign an existing connection to the connection reference.

Select a connector to the connection references.

- A. Mastered  
B. Not Mastered

Answer: A

Explanation:

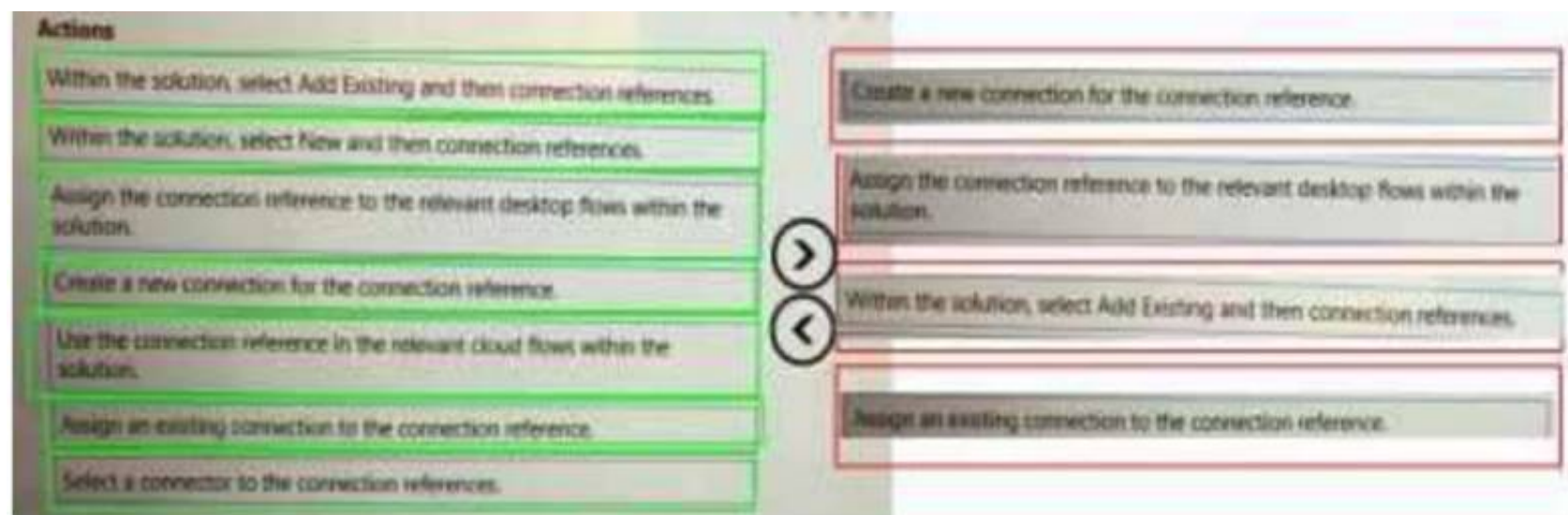

### NEW QUESTION 112

- (Exam Topic 3)

A company stores confidential documents in a SharePoint document library.

A developer must create an automation solution in a default environment that processes documents from the SharePoint library and uploads approved documents to Azure File Storage for archiving purposes. The automation must meet the following requirements:

- Prevent modification or deletion of approved documents from Azure File Storage.
- Prevent sharing of documents from SharePoint or Azure File Storage. You need to configure a data loss prevention (DLP) policy.

Which five actions should you perform in sequence? To answer, move the appropriate actions from the list of actions to the answer area and arrange them in the correct order.

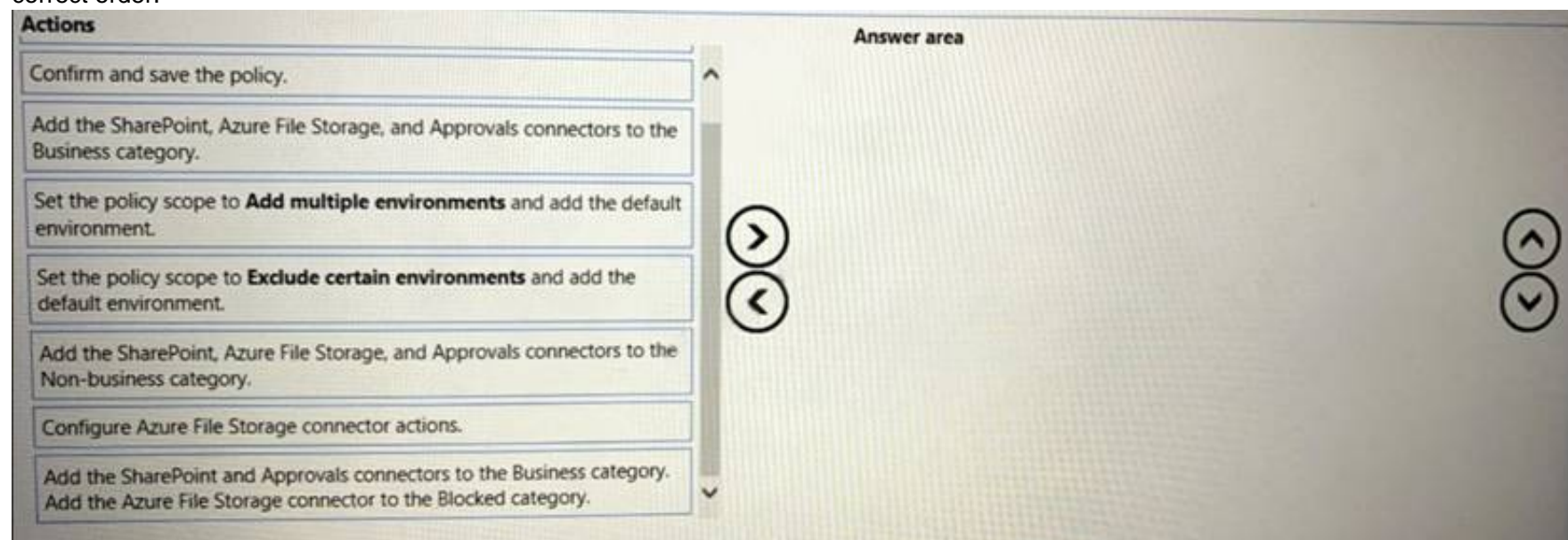

- A. Mastered
- B. Not Mastered

Answer: A

Explanation:

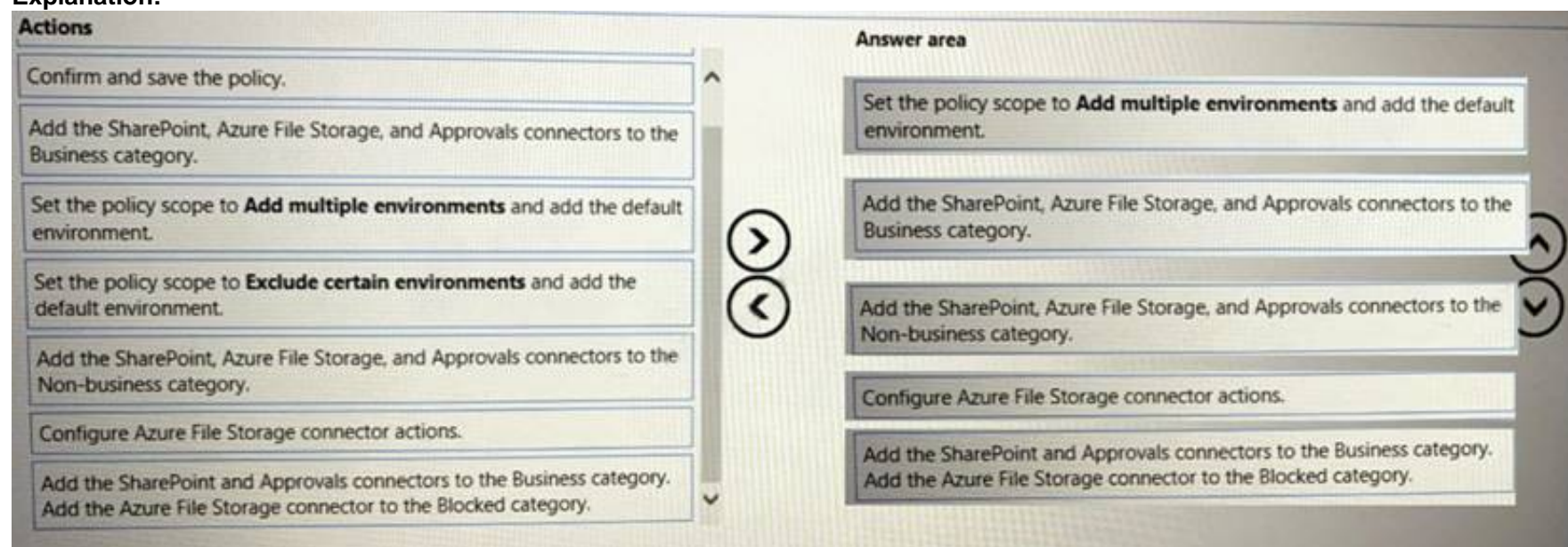

### NEW QUESTION 114

- (Exam Topic 3)

A client would like you to create a custom connector. You need to configure the connector. Which element is required?

- A. API Key
- B. On-premises data gateway
- C. Power Automate per user license
- D. JSON sample for request
- E. Power Automate per flow license

Answer: C

NEW QUESTION 115

.....



## Thank You for Trying Our Product

### We offer two products:

1st - We have Practice Tests Software with Actual Exam Questions

2nd - Questons and Answers in PDF Format

### PL-500 Practice Exam Features:

- \* PL-500 Questions and Answers Updated Frequently
- \* PL-500 Practice Questions Verified by Expert Senior Certified Staff
- \* PL-500 Most Realistic Questions that Guarantee you a Pass on Your FirstTry
- \* PL-500 Practice Test Questions in Multiple Choice Formats and Updatesfor 1 Year

**100% Actual & Verified — Instant Download, Please Click**  
**[Order The PL-500 Practice Test Here](#)**